



Knob Noster R-VIII School District

401 E. Wimer, Knob Noster, MO 65336
Office: (660) 563-3186 Fax: (660) 563-3026
Student Services: (660) 563-5597

Dr. Jerrod Wheeler, Superintendent of Schools

Mr. Michael Cohron, Assistant Superintendent of Schools

Dr. Angela Rolofson, Director, Student Services

Our Mission Is Student Success

Date: March 31, 2020

To: Knob Noster Public Schools Community

From: Jeff Davis, Director of Technology

RE: Covid-19 Update (15) – Technology Tips for Virtual Learning

KN Parents/Guardians,

I am writing after the first day of virtual learning with several technology tips that will be helpful as your child learns remotely at Knob Noster Public Schools.

How to Change to a Private Network

Earlier yesterday I shared instructions on changing this setting on your student's device. The private network setting can allow better connection capabilities to various websites and is recommended for all student devices. It is also recommended that students restart their laptop after changing to a private network. Step-by-step instructions are provided in an attached document. (pages 3-5)

Tips to Help Wi-Fi Speed During Virtual School

Internet speeds are affected due to the large volume of users online during the Covid-19 situation. I am providing tips in the attached document that may help your child's online experience during virtual learning. (page 6)

Troubleshooting Google Classroom

If your student experiences problems with Google Classroom, the following link from Google Support provides solutions to common issues that are encountered:

<https://support.google.com/edu/classroom/answer/6315899>

Laptop Pick Up and Repair - Today

The Technology Department will be available **4:30-6:30 p.m. today, Tuesday, March 31** at Knob Noster High School. This time is designated for laptop pick up and repair swap out.

KNPS Wi-Fi Mobile Hotspot Passwords

If students utilize the Wi-Fi mobile hotspot locations at our schools, please use the information below.

Wi-Fi SSID: KNSD-PUBLIC

Password: panthers (all lowercase)

If your family has contacted the school district to utilize a hotspot mobile location provided by a school bus, you will use the logon credentials below.

Wi-Fi SSID: KNSD-BUS## (will appear with bus number)

Password: panthers (all lowercase).

Sincerely,

Jeff Davis, Director of Technology

Knob Noster Public Schools

How to Change to a Private Network

1. Click on the Start Button



2. Click Setting Icon



3. Click Network & Internet

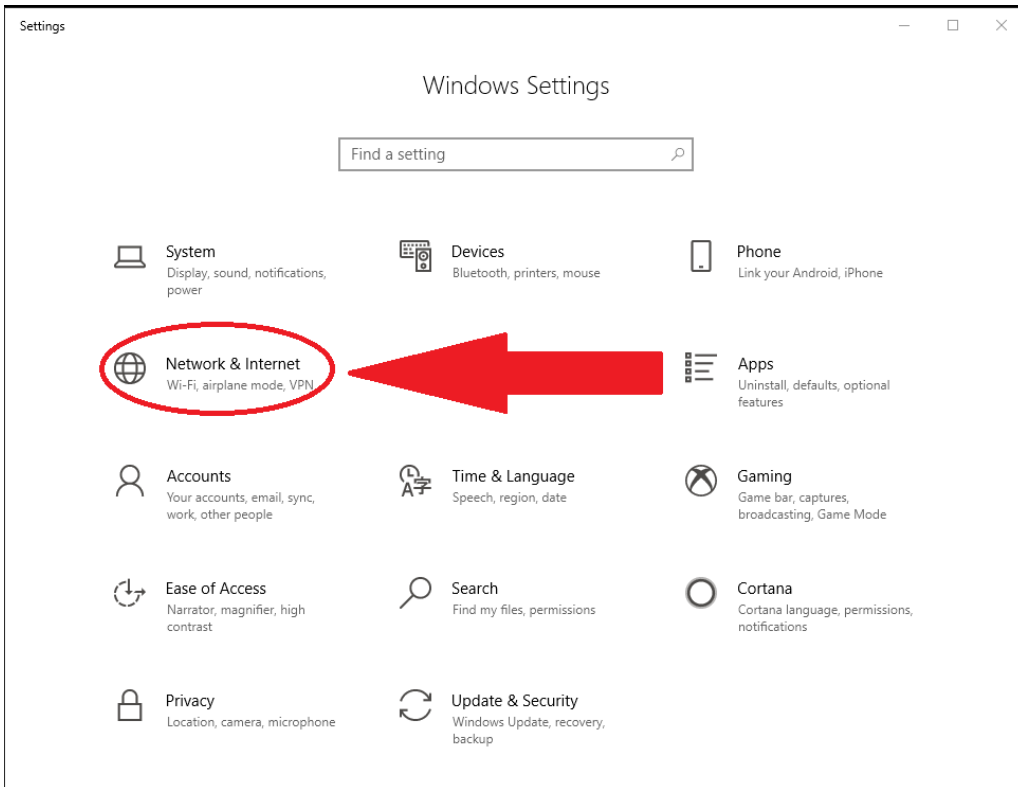

4. If you are on Wi-Fi Click it, if you are plugged in click Ethernet.

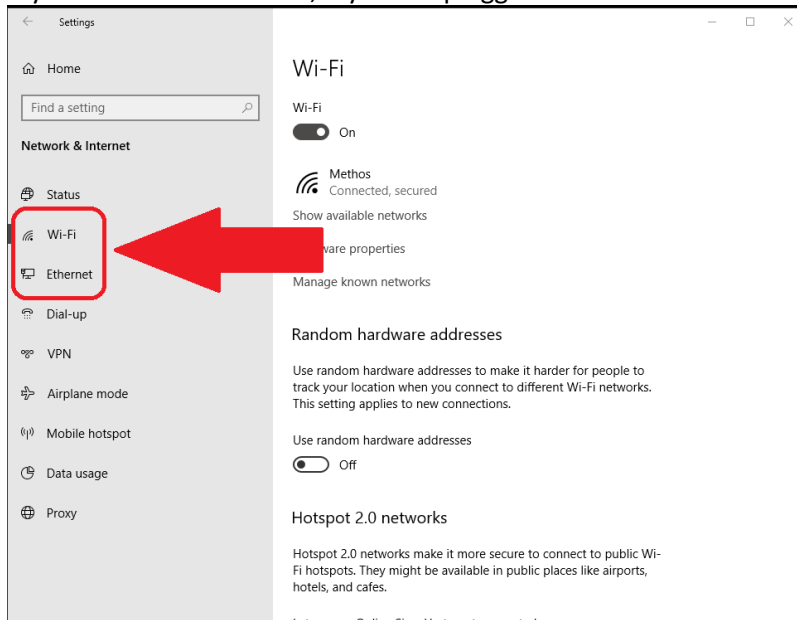

5. If you are on Wi-Fi, click the name of your connection and then click Private.

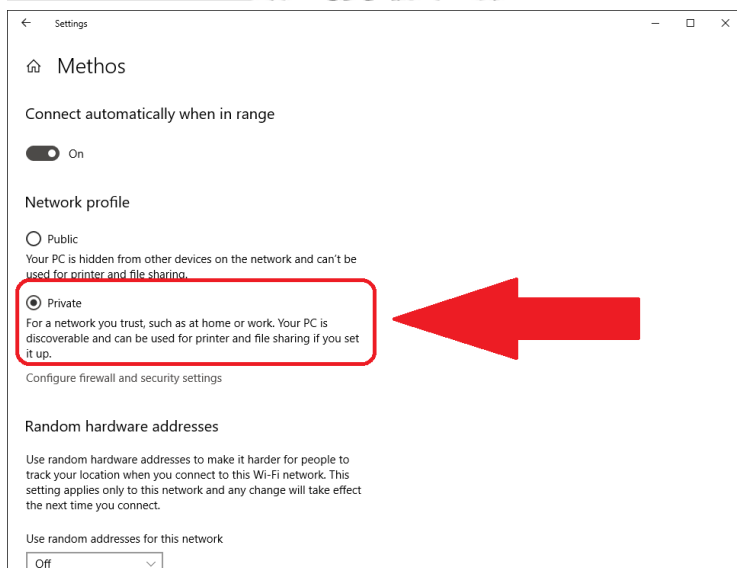
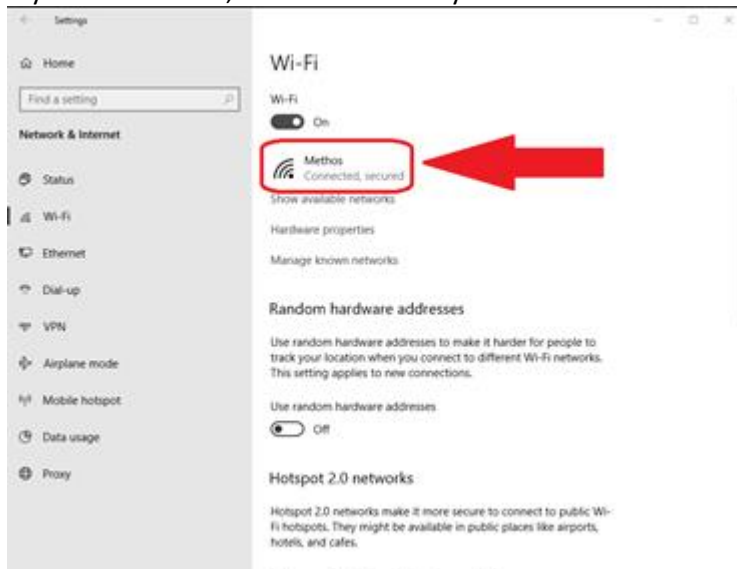

If you are Plugged in, choose Ethernet and then click Private

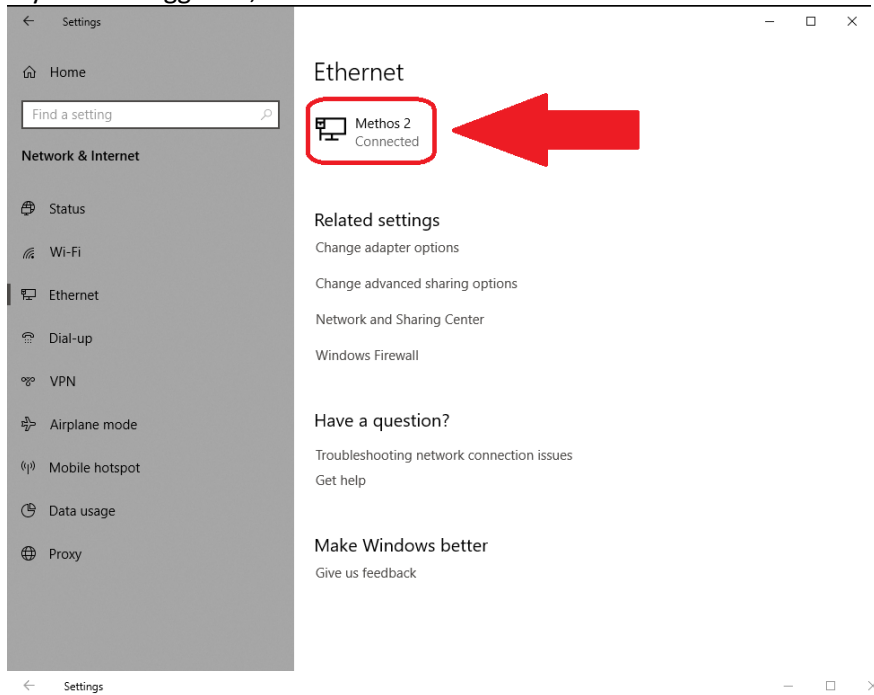

Methos 2

Network profile

☐ Public

Your PC is hidden from other devices on the network and can't be used for printer and file sharing.

☒ Private

For a network you trust, such as at home or work. Your PC is discoverable and can be used for printer and file sharing if you set it up.

[Configure firewall and security settings](#)

Metered connection

If you have a limited data plan and want more control over data usage, make this connection a metered network. Some apps might work differently to reduce data usage when you're connected to this network.

Set as metered connection

☐ Off

If you set a data limit, Windows will set the metered connection setting for you to help you stay under your limit.

[Set a data limit to help control data usage on this network](#)

6. You are now on a private network and can close the windows.

Help with speed on your WIFI during virtual school!

1. Temporarily Disconnect Cell phones from WIFI.
2. Temporarily Disconnect Gaming Consoles from WIFI.
3. Temporarily Disconnect Dish/DirecTV from WIFI.
4. Temporarily stop streaming media (YouTube, Netflix, Amazon Video, Disney +, Hulu)
5. Be as close to the WIFI access point as possible with the student device to ensure a good signal.
6. If it appears the laptop is running slowly reboot the laptop This can be accomplished by clicking on the start menu (Windows icon, bottom left of the screen), then right-clicking the power icon and selecting "Restart". If needed, a restart can also be performed by holding down the physical power button for 10-15 seconds, then turning the machine back on.
7. If possible, have the laptop plugged in while you are using it – this will bypass power saving settings imposed by Windows.
8. It is possible that the AVG Anti-Virus is scanning the laptop. The scan can be disabled by Double Clicking on the AVG Icon on the desktop. Once the program is visible on the screen, if you see Scanning in the Green button at the bottom, press it and Stop/Pause the scan.
9. Only open the tabs and applications needed for your school work.

Close all the others.